



优钻地质材料供应有限公司

PRE-MAT DRILLING SUPPLIES PTE LTD

Co Reg. No. 199900213-K GST Reg. No. 19-9900213-K

No. 48 Toh Guan Road East #06-107 Enterprise Hub, Singapore 608586

Tel: (65) 6861 5323 Fax: (65) 6861 0882 Mobile: (65) 9633 1617 / (65) 9665 2712

Email: enquiry@premat.com.sg Website: http://www.premat.com.sg

LIFTING & LOWERING TOOLS



HOISTING WATER SWIVEL

This hoisting water swivel is so designed as to send water into the rotating drill rod during lifting and lowering.



FOOT CLAMP

This foot clamp allows you to change the jaws to suit various diameters of drill rod and casing.

Jaws available in NQ, HQ, BW, NW Drill Rod; NW, HW, PW Casing

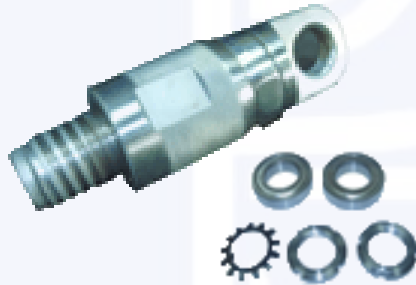

HOISTING PLUG (HOISTING SWIVEL)

This is connected to a rope socket and is used when lifting and lowering the drill rods.



CASING BAND/CLAMP

This tool is used to hold a rod retained in a hole, when pulling it up by means of jacks.



Replaceable Spare Jaws



DRIVE HAMMER WITH CHAIN

This tool is used for hammering up and recovering drill strings which are jammed in a hole. In addition, the drive hammer is also used to strike in/up drive pipes for S.P.T.



ROD HOLDER

This is a tool used for holding the drill rods while they are being hoisted or lowered.

Jaws are interchangeable among rod holders of the same model

Nominal Weight, kg	40	63.5	100	150
Applied Rod Diameter, mm	Up to 40.5	Up to 50	Up to 73	Up to 127

KNOCKING BLOCK

This is a collar fixed at the upper end or joint of rods and is used to receive the impact when hammering up or down.